

Wall-mounted ceiling washlights provide indirect ambient lighting and create a bright and friendly atmosphere in the space. A task light on the desk provides direct light on the working plane when required.

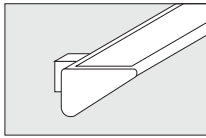

Wall-mounted ceiling washlight for fluorescent lamps or compact fluorescent lamps.

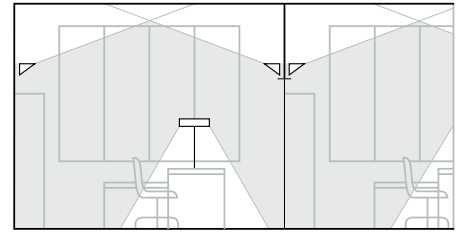
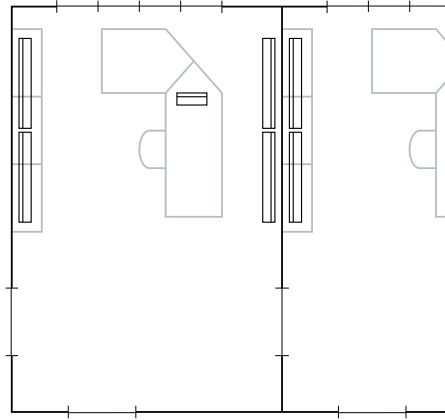
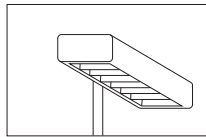

Task light for compact fluorescent lamps.

Track system spanned from wall to wall with low-brightness luminaires as well as spotlights for the accentuation of specific points of interest or importance.

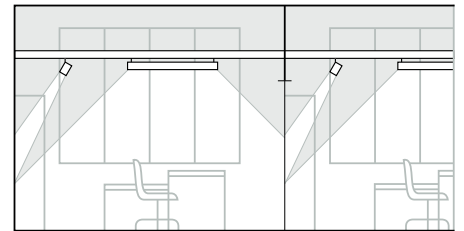
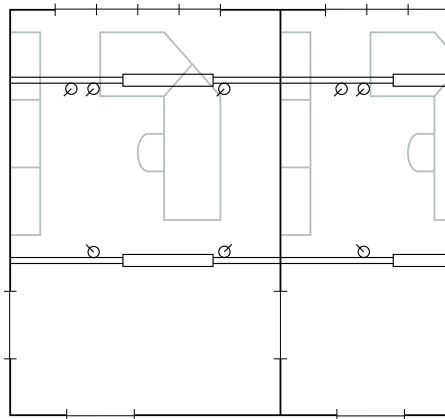

Track system with low-brightness luminaires for fluorescent lamps, and spotlights.

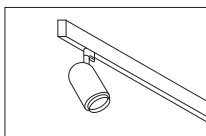
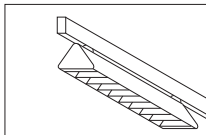

The ambient lighting in the office is provided by four recessed indirect secondary reflector luminaires. The indirect component is reflected into the space by the satin finished reflector. The luminaire layout is workplace-related with lower illuminance in the circulation area.

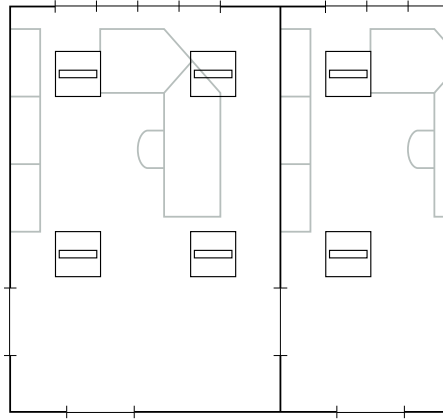

Recessed secondary reflector luminaires for compact fluorescent lamps.

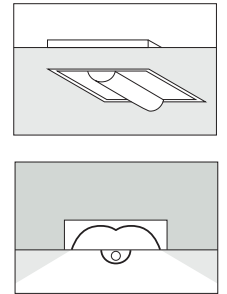

Office lighting illuminance is provided by two suspended light structure elements parallel to the windows, with integral direct-indirect luminaires and integral directional luminaires to accentuate the desk and other points of interest.

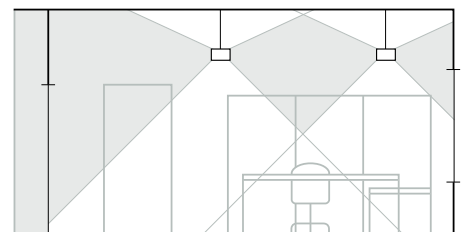
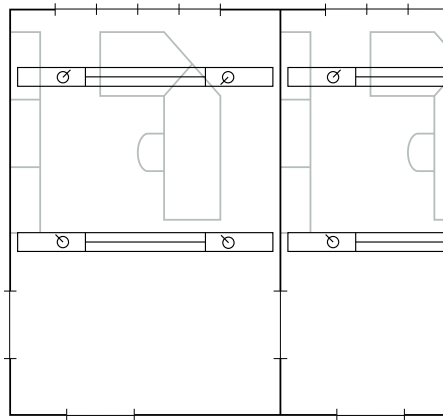

Light structure with integral direct-indirect luminaires for fluorescent lamps and downlights for low-voltage halogen lamps.

